

GLOBAL IMPACT PRODUCTS, LLC.

SERIES 3063 - FIXED ALUMINUM WINDOW (HVHZ)(IMPACT)

GENERAL NOTES:

1. THE PRODUCT SHOWN HEREIN IS DESIGNED AND MANUFACTURED TO COMPLY WITH THE CURRENT EDITION FLORIDA BUILDING CODE (FBC), **INCLUDING** HVHZ AND HAS BEEN EVALUATED ACCORDING TO THE FOLLOWING:
 - TAS 201-94
 - TAS 202-94
 - TAS 203-94
2. ADEQUACY OF THE EXISTING STRUCTURAL CONCRETE/MASONRY, 2X FRAMING, AND METAL FRAMING AS A MAIN WIND FORCE RESISTING SYSTEM CAPABLE OF WITHSTANDING AND TRANSFERRING APPLIED PRODUCT LOADS TO THE FOUNDATION IS THE RESPONSIBILITY OF THE ENGINEER OR ARCHITECT OF RECORD FOR THE PROJECT OF INSTALLATION.
3. 1X AND 2X BUCKS (WHEN USED) SHALL BE DESIGNED AND ANCHORED TO PROPERLY TRANSFER ALL LOADS TO THE STRUCTURE. BUCK DESIGN AND INSTALLATION IS THE RESPONSIBILITY OF THE ENGINEER OR ARCHITECT OF RECORD FOR THE PROJECT OF INSTALLATION.
4. INSTALL INDIVIDUAL INSTALLATION ANCHORS WITHIN A TOLERANCE OF ±1/4 INCH OF THE DEPICTED LOCATION IN THE ANCHOR LAYOUT DETAIL (I.E., WITHOUT CONSIDERATION OF TOLERANCES). TOLERANCES ARE NOT CUMULATIVE FROM ONE INSTALLATION ANCHOR TO THE NEXT.
5. THE INSTALLATION DETAILS DESCRIBED HEREIN ARE GENERIC AND MAY NOT REFLECT ACTUAL CONDITIONS FOR A SPECIFIC SITE. IF SITE CONDITIONS CAUSE INSTALLATION TO DEVIATE FROM THE REQUIREMENTS DETAILED HEREIN, A LICENSED ENGINEER OR ARCHITECT SHALL PREPARE SITE SPECIFIC DOCUMENTS FOR USE WITH THIS DOCUMENT.
6. APPROVED IMPACT PROTECTIVE SYSTEM **IS NOT REQUIRED** ON THIS PRODUCT IN AREAS REQUIRING IMPACT RESISTANCE.
7. WINDOW FRAME MATERIAL: ALUMINUM (6063-T5)
8. GLASS MEETS THE REQUIREMENTS OF ASTM E 1300 GLASS CHARTS. SEE SHEET 1 FOR GLAZING DETAIL.

DESIGN RATING				
OVERALL SIZE		CONFIGURATION	DESIGN PRESSURE	MISSILE IMPACT RATING
WIDTH	HEIGHT			
60" x 120"		"O"	+100/-100 PSF	LARGE & SMALL MISSILE IMPACT RATED

TABLE OF CONTENTS	
SHEET	SHEET DESCRIPTION
1	GENERAL NOTES AND GLAZING DETAIL
2	ELEVATION AND ANCHOR LAYOUTS
3	VERTICAL SECTION
4	HORIZONTAL SECTION
5	ANCHOR DETAILS AND INSTALLATION NOTES
6	COMPONENTS AND BILL OF MATERIALS

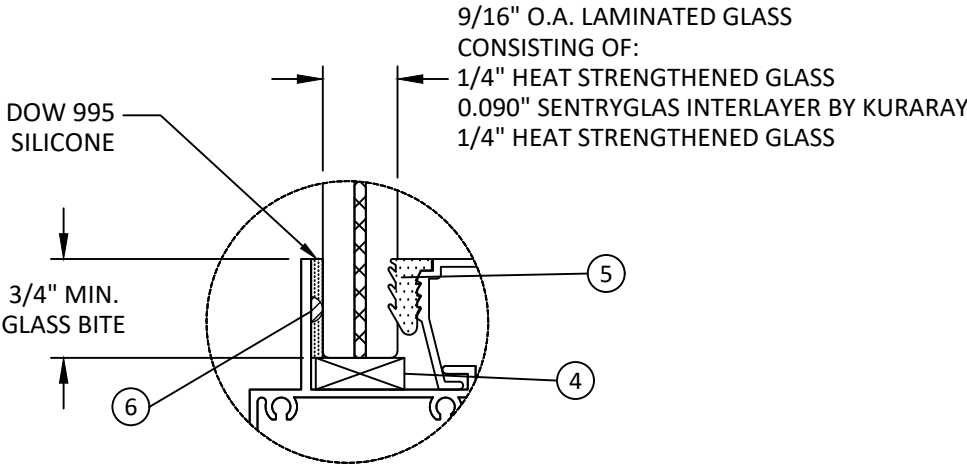

GLAZING DETAIL 1

- GLAZING NOTES:
1. GLASS TYPE COMPLIES WITH ASTM E1300 REQUIREMENTS. PER THE FBC TEMPER AND SAFETY GLAZING REQUIREMENTS SHALL BE REVIEWED ON A SITE SPECIFIC BASIS.
2. SETTING BLOCK DUROMETER HARDNESS OF 70-90 (SHORE A) AS REFERENCED IN FBC CHAPTER 24.
3. SETTING BLOCKS TO BE LOCATED AT 1/4 SPAN LENGTH FOR GLASS WIDER THAN 36" AS PER FBC CHAPTER 24.
4. D.L.O. AND DESIGN PRESSURES MAY NOT EXCEED MAX VALUES SHOWN HEREIN.



GLOBAL IMPACT PRODUCTS
1963 WEST MCNAB RD,
POMPANO BEACH, FL 33069
PH: (561) 346-3649

TITLE:
SERIES 3063 - FIXED ALUMINUM WINDOW (HVHZ)(IMPACT)
GENERAL NOTES AND GLAZING DETAIL

PREPARED BY:
BUILDING DROPS, INC.
1900 NE MIAMI CT. SUITE 2-15
MIAMI, FL 33132
PH: (954)399-8478
FAX: (954)744-4738
WEB: www.buildingdrops.com



REMARKS	BY	DATE

THE INSTALLATION DETAILS DESCRIBED HEREIN ARE GENERIC AND MAY NOT REFLECT ACTUAL CONDITIONS FOR A SPECIFIC SITE. IF SITE CONDITIONS CAUSE INSTALLATION TO DEVIATE FROM THE REQUIREMENTS DETAILED HEREIN, A LICENSED ENGINEER OR ARCHITECT SHALL PREPARE SITE SPECIFIC DOCUMENTS FOR USE WITH THIS DOCUMENT.



FL #:
FL46906

DATE: **07.12.2024**

DWG. BY: FB	CHK. BY: HFN
-----------------------	------------------------

SCALE: **NTS**

DWG. #: **GIP008**

SHEET:
1
OF 6

c:\users\franciscobreno\building drops, inc\building drops landing - common\projects\global industries & mfg., inc. (global impact products)\fb-22-0537 - fbc submittal - r31158 aluminum fixed window\dwg\gip008 - (07.12).dwg 8/23/2024 2:55 PM

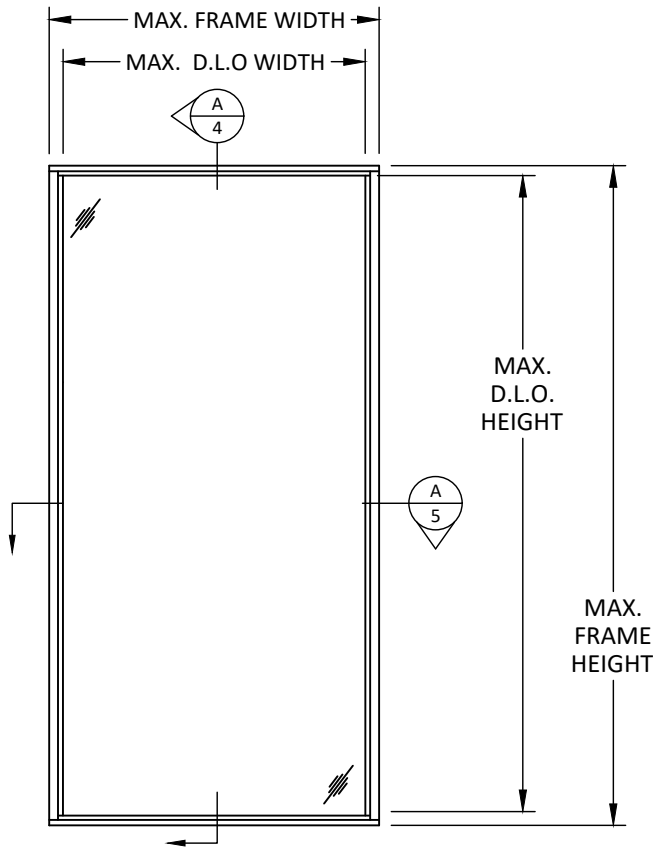

ELEVATION

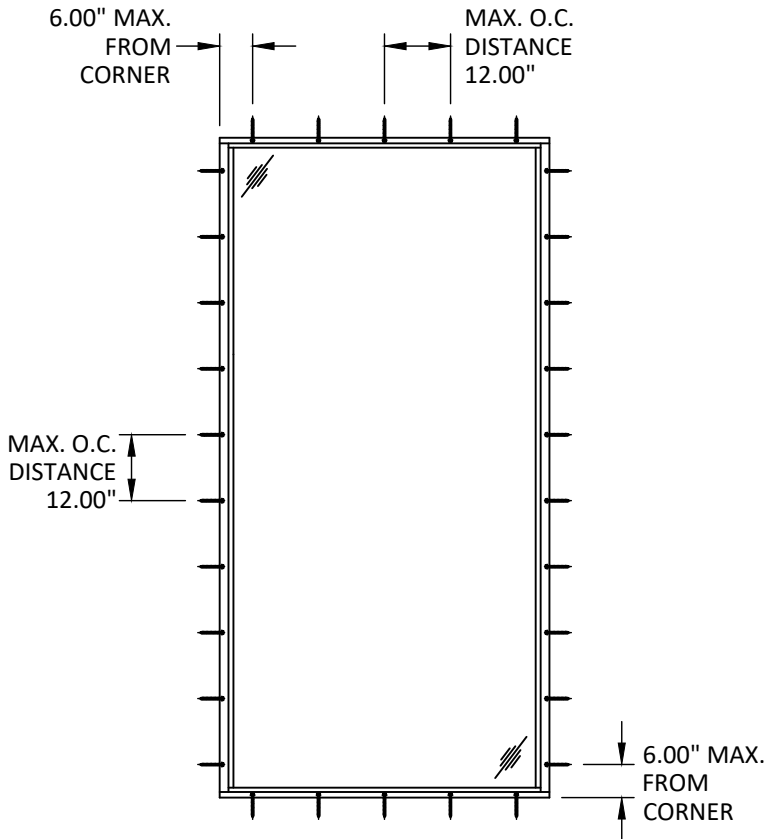

ANCHOR LAYOUT
THROUGH FRAME

SERIES 3063 - FIXED WINDOW DESIGN PRESSURE TABLE (+/- PSF)																					
FRAME HEIGHT (IN.)	FRAME WIDTH (IN.)																				
		36	42	48	54	60	66	72	78	84	90	96	102	108	114	120	126	132	138	144	150
	48	100.0	100.0	100.0	100.0	100.0	100.0	100.0	100.0	100.0	100.0	100.0	100.0	100.0	100.0	100.0	100.0	100.0	100.0	100.0	100.0
	54	100.0	100.0	100.0	100.0	100.0	100.0	100.0	100.0	100.0	100.0	100.0	100.0	100.0	100.0	100.0	100.0	100.0	-	-	-
	60	100.0	100.0	100.0	100.0	100.0	100.0	100.0	100.0	100.0	100.0	100.0	100.0	100.0	100.0	100.0	-	-	-	-	-
	66	100.0	100.0	100.0	100.0	100.0	90.9	90.9	90.9	90.9	90.9	90.9	90.9	90.9	-	-	-	-	-	-	-
	72	100.0	100.0	100.0	100.0	100.0	90.9	83.3	83.3	83.3	83.3	83.3	-	-	-	-	-	-	-	-	-
	78	100.0	100.0	100.0	100.0	100.0	90.9	83.3	76.9	76.9	76.9	-	-	-	-	-	-	-	-	-	-
	84	100.0	100.0	100.0	100.0	100.0	90.9	83.3	76.9	71.4	-	-	-	-	-	-	-	-	-	-	-
	90	100.0	100.0	100.0	100.0	100.0	90.9	83.3	76.9	-	-	-	-	-	-	-	-	-	-	-	-
	96	100.0	100.0	100.0	100.0	100.0	90.9	83.3	-	-	-	-	-	-	-	-	-	-	-	-	-
	102	100.0	100.0	100.0	100.0	100.0	90.9	-	-	-	-	-	-	-	-	-	-	-	-	-	-
	108	100.0	100.0	100.0	100.0	100.0	90.9	-	-	-	-	-	-	-	-	-	-	-	-	-	-
	114	100.0	100.0	100.0	100.0	100.0	-	-	-	-	-	-	-	-	-	-	-	-	-	-	-
	120	100.0	100.0	100.0	100.0	100.0	-	-	-	-	-	-	-	-	-	-	-	-	-	-	-
	126	100.0	100.0	100.0	100.0	-	-	-	-	-	-	-	-	-	-	-	-	-	-	-	-
	132	100.0	100.0	100.0	100.0	-	-	-	-	-	-	-	-	-	-	-	-	-	-	-	-
	138	100.0	100.0	100.0	-	-	-	-	-	-	-	-	-	-	-	-	-	-	-	-	-
	144	100.0	100.0	100.0	-	-	-	-	-	-	-	-	-	-	-	-	-	-	-	-	-
	150	100.0	100.0	100.0	-	-	-	-	-	-	-	-	-	-	-	-	-	-	-	-	-
	156	100.0	100.0	-	-	-	-	-	-	-	-	-	-	-	-	-	-	-	-	-	-

FIXED WINDOW - D.L.O. DIMENSIONS:

D.L.O. HEIGHT: FRAME HEIGHT - 2-9/16"
D.L.O. WIDTH: FRAME WIDTH - 2-9/16"

NOTE: SEE SHEET 5 FOR
ANCHOR DETAILS.



GLOBAL IMPACT PRODUCTS
1963 WEST MCNAB RD,
POMPANO BEACH, FL 33069
PH: (561) 346-3649

TITLE:
SERIES 3063 - FIXED ALUMINUM
WINDOW
(HVHZ/IMPACT)
ELEVATION AND
DESIGN PRESSURE TABLE

PREPARED BY:
BUILDING DROPS, INC.
1900 NE MIAMI CT, SUITE 2-15
MIAMI, FL 33132
PH: (954)399-8478
FAX: (954)744-4738
WEB: www.buildingdrops.com



REMARKS	BY	DATE

THE INSTALLATION DETAILS DESCRIBED HEREIN ARE GENERIC
AND MAY NOT REFLECT ACTUAL CONDITIONS FOR A SPECIFIC
SITE. IF SITE CONDITIONS CAUSE INSTALLATION TO DEVIATE
FROM THE REQUIREMENTS DETAILED HEREIN, A LICENSED
ENGINEER OR ARCHITECT SHALL PREPARE SITE SPECIFIC
DOCUMENTS FOR USE WITH THIS DOCUMENT.



FL #:	FL46906
DATE:	07.12.2024
DWG. BY:	CHK. BY:
FB	HFN
SCALE:	NTS
DWG. #:	GIP008
SHEET:	2 OF 6

c:\users\franciscobriceno\building drops, inc\building drops landing - common\projects\global industries & mfg., inc. (global impact products)\fbp submittal - f31158 aluminum fixed window\dwgs\gip008 - (07.12).dwg 8/23/2024 2:55 PM

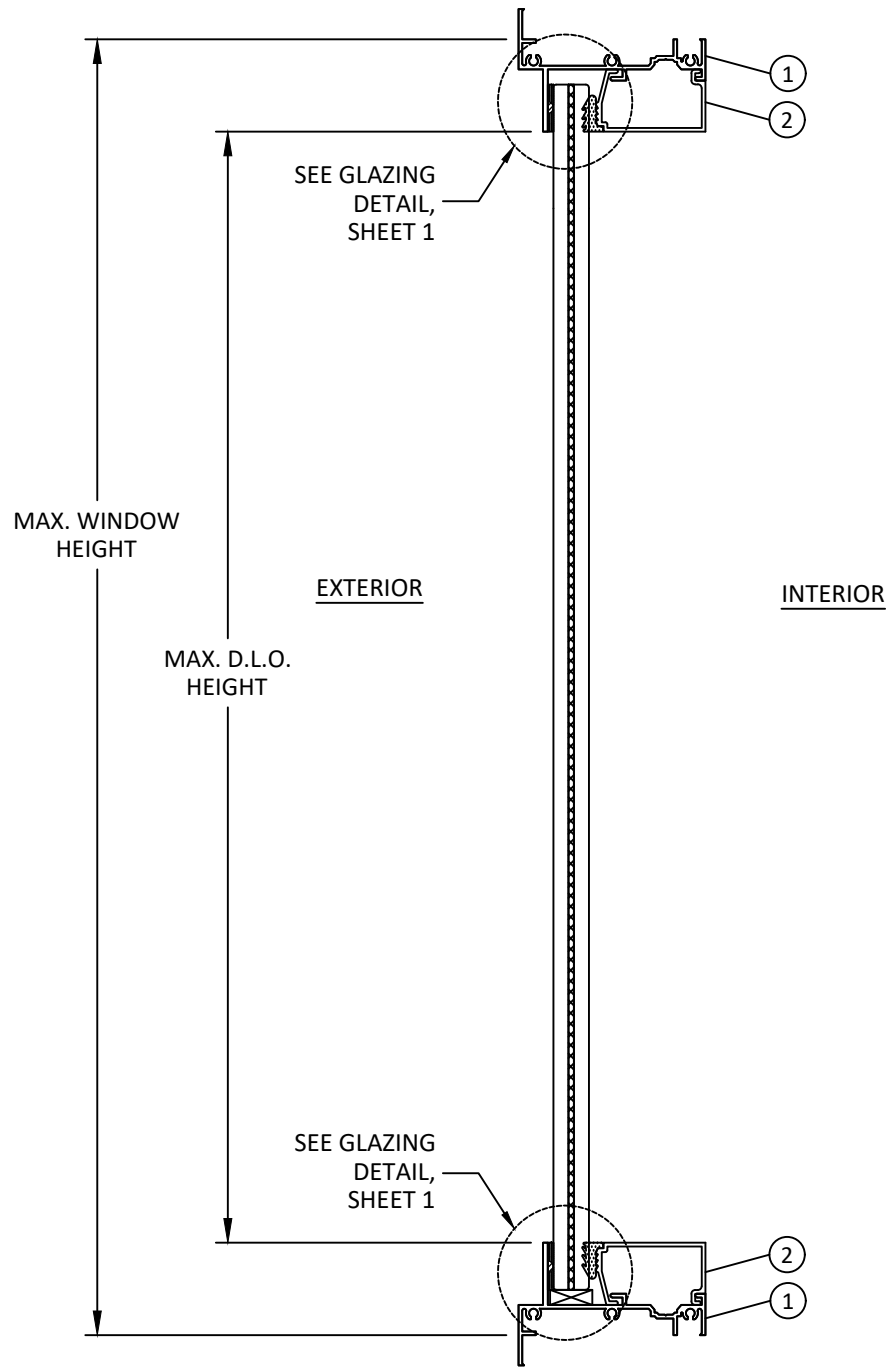

A
3 VERTICAL SECTION
TYP. HEAD/SILL



GLOBAL IMPACT PRODUCTS
1963 WEST MCNAB RD,
POMPANO BEACH, FL 33069
PH: (561) 346-3649

TITLE:
SERIES 3063 - FIXED ALUMINUM
WINDOW
(HVHZ/IMPACT)
VERTICAL SECTION

PREPARED BY:
BUILDING DROPS, INC.
1900 NE MIAMI CT. SUITE 2-15
MIAMI, FL 33132
PH: (954)399-8478
FAX: (954)744-4738
WEB: www.buildingdrops.com



REMARKS	BY	DATE

THE INSTALLATION DETAILS DESCRIBED HEREIN ARE GENERIC AND MAY NOT REFLECT ACTUAL CONDITIONS FOR A SPECIFIC SITE. IF SITE CONDITIONS CAUSE INSTALLATION TO DEVIATE FROM THE REQUIREMENTS DETAILED HEREIN, A LICENSED ENGINEER OR ARCHITECT SHALL PREPARE SITE SPECIFIC DOCUMENTS FOR USE WITH THIS DOCUMENT.



FL #:
FL46906

DATE: **07.12.2024**

DWG. BY: FB	CHK. BY: HFN
-----------------------	------------------------

SCALE: **NTS**

DWG. #: **GIP008**

SHEET:

3

OF 6

c:\users\franciscobreno\building drops, inc\building drops landing - common\projects\global industries & mfg., inc. (global impact products)\fbc-22-0537 - fbc submittal - r31158 aluminum fixed window\dwg\gip008 - (07.12).dwg 8/23/2024 2:55 PM

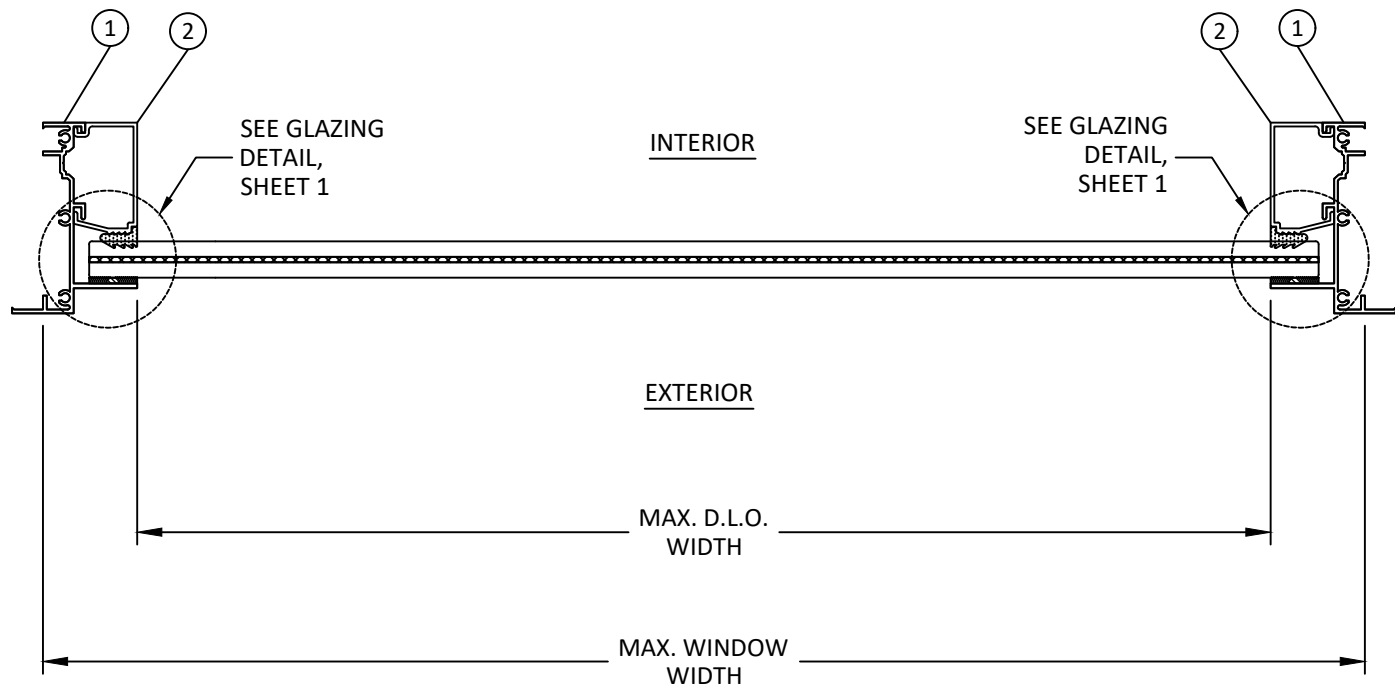

A HORIZONTAL SECTION
4 TYP. JAMB



GLOBAL IMPACT PRODUCTS
1963 WEST MCNAB RD,
POMPANO BEACH, FL 33069
PH: (561) 346-3649

TITLE: SERIES 3063 - FIXED ALUMINUM WINDOW (HVHZ)/(IMPACT) HORIZONTAL SECTION

PREPARED BY: **BUILDING DROPS, INC.**
1900 NE MIAMI CT. SUITE 2-15
MIAMI, FL 33132
PH: (954)399-8478
FAX: (954)744-4738
WEB: www.buildingdrops.com



REMARKS	BY	DATE

THE INSTALLATION DETAILS DESCRIBED HEREIN ARE GENERIC AND MAY NOT REFLECT ACTUAL CONDITIONS FOR A SPECIFIC SITE. IF SITE CONDITIONS CAUSE INSTALLATION TO DEVIATE FROM THE REQUIREMENTS DETAILED HEREIN, A LICENSED ENGINEER OR ARCHITECT SHALL PREPARE SITE SPECIFIC DOCUMENTS FOR USE WITH THIS DOCUMENT.



FL #: **FL46906**

DATE: **07.12.2024**

DWG. BY: **FB** CHK. BY: **HFN**

SCALE: **NTS**

DWG. #: **GIP008**

SHEET:

4

OF 6

c:\users\franciscobriceno\building drops, inc\building drops landing - common\projects\global industries & mfg., inc. (global impact products)\fbp-submittal - f31158 aluminum fixed window\dwg\gip008 - (07.12).dwg
8/23/2024 2:55 PM

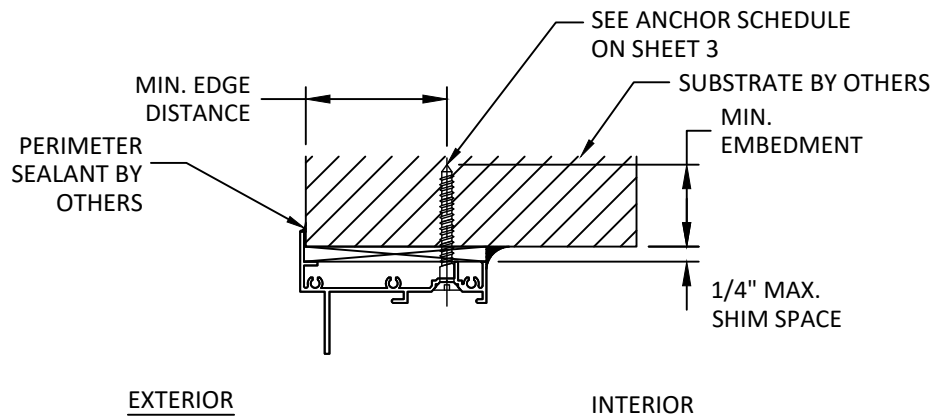

A
5 VERTICAL SECTION
TYP. HEAD INSTALLATION
THROUGH FRAME

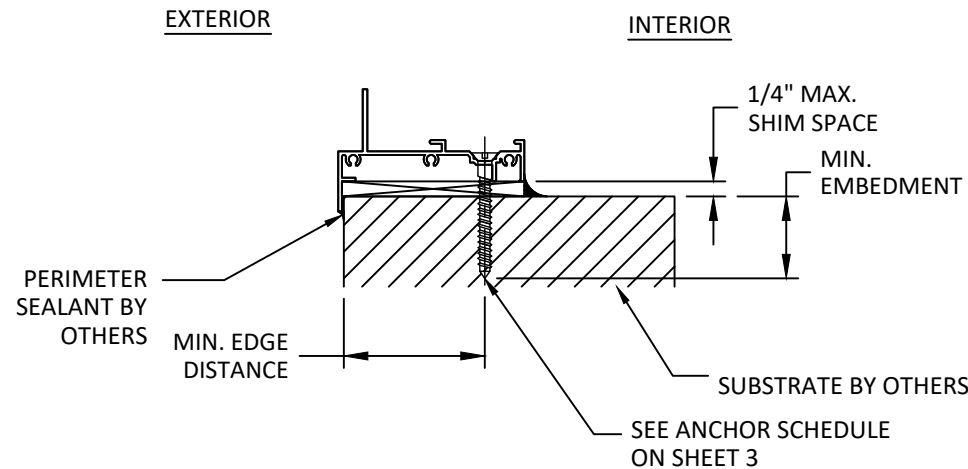

C
5 HORIZONTAL SECTION
TYP. SILL INSTALLATION
THROUGH FRAME

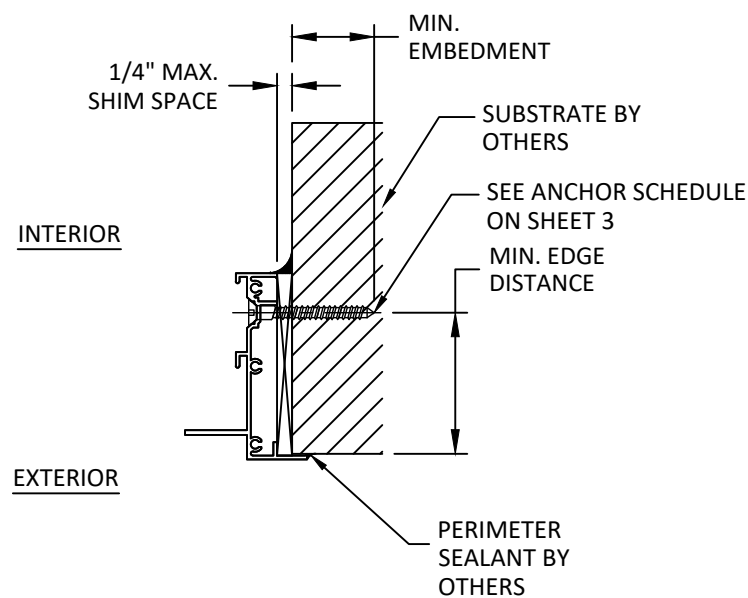

B
5 VERTICAL SECTION
TYP. JAMB INSTALLATION
THROUGH FRAME

ANCHOR SCHEDULE - SERIES 3063 FIXED ALUMINUM WINDOW				
INST. METHOD	ANCHOR TYPE	SUBSTRATE	MIN. EMBEDMENT	MIN. EDGE DISTANCE
THROUGH FRAME	#14 WOOD SCREW	WOOD (S.G. = 0.55)	1.50"	0.50"
	1/4" SELF-TAPPING SCREW	MIN. 18 GA. STEEL (33KSI)/ ALUMINUM 1/8" MIN. THK. 6063-T5	THREE (3) THREADS MIN.. PENETRATION BEYOND METAL FACE	0.50"
	1/4" ULTRACON+	CONCRETE: f'c = 3000 PSI	1.25"	2.00"
	1/4" ULTRACON+	MASONRY : CMU PER ASTM-C90, MIN. 2000 PSI	1.75"	2.00"

INSTALLATION NOTES:

- ONE (1) INSTALLATION ANCHOR IS REQUIRED AT EACH ANCHOR LOCATION SHOWN, UNLESS OTHERWISE STATED ON SHEET 3.
- INSTALL INDIVIDUAL INSTALLATION ANCHORS WITHIN A TOLERANCE OF ± 1.000 INCH THE DEPICTED LOCATION & SPACING IN THE ANCHOR LAYOUT DETAILS (I.E., WITHOUT CONSIDERATION OF TOLERANCES). TOLERANCES ARE NOT CUMULATIVE FROM ONE INSTALLATION ANCHOR TO THE NEXT.
- SHIM AS REQUIRED AT EACH INSTALLATION ANCHOR WITH LOAD BEARING SHIM(S). MAXIMUM ALLOWABLE SHIM STACK TO BE 1/4 INCH. SHIM WHERE SPACE OF 1/16 INCH OR GREATER OCCURS. SHIM(S) SHALL BE CONSTRUCTED OF HIGH DENSITY PLASTIC OR BETTER.
- MINIMUM EMBEDMENT AND EDGE DISTANCE EXCLUDE WALL FINISHES, INCLUDING BUT NOT LIMITED TO STUCCO, FOAM, BRICK VENEER, AND SIDING.
- INSTALLATION ANCHORS AND ASSOCIATED HARDWARE MUST BE MADE OF CORROSION RESISTANT MATERIAL OR HAVE A CORROSION RESISTANT COATING.
- FOR MASONRY OR CONCRETE OPENINGS, A 1X WOOD BUCK MAY BE USED (OPTIONAL) AS LONG AS THE MINIMUM EMBEDMENT AND EDGE DISTANCE REQUIREMENTS ARE STILL MET WITHIN THE CORRESPONDING HOST SUBSTRATE. SEE GENERAL NOTE #3 ON SHEET 1 FOR MORE INFORMATION.
- FOR HOLLOW BLOCK AND GROUT FILLED BLOCK, DO NOT INSTALL INSTALLATION ANCHORS INTO MORTAR JOINTS. EDGE DISTANCE IS MEASURED FROM FREE EDGE OF BLOCK OR EDGE OF MORTAR JOINT INTO FACE SHELL OF BLOCK.
- INSTALLATION ANCHORS SHALL BE INSTALLED IN ACCORDANCE WITH ANCHOR MANUFACTURER'S INSTALLATION INSTRUCTIONS, AND ANCHORS SHALL NOT BE USED IN SUBSTRATES WITH STRENGTHS LESS THAN THE MINIMUM STRENGTH SPECIFIED BY THE ANCHOR MANUFACTURER.



GLOBAL IMPACT PRODUCTS
1963 WEST MCNAB RD,
POMPANO BEACH, FL 33069
PH: (561) 346-3649

TITLE: SERIES 3063 - FIXED ALUMINUM WINDOW (HVHZ/IMPACT) ANCHOR DETAILS AND INSTALLATION NOTES

PREPARED BY: BUILDING DROPS, INC.
1900 NE MIAMI CT, SUITE 2-15
MIAMI, FL 33132
PH: (954) 399-8478
FAX: (954) 744-4738
WEB: www.buildingdrops.com



REMARKS	BY	DATE

THE INSTALLATION DETAILS DESCRIBED HEREIN ARE GENERIC AND MAY NOT REFLECT ACTUAL CONDITIONS FOR A SPECIFIC SITE. IF SITE CONDITIONS CAUSE INSTALLATION TO DEVIATE FROM THE REQUIREMENTS DETAILED HEREIN, A LICENSED ENGINEER OR ARCHITECT SHALL PREPARE SITE SPECIFIC DOCUMENTS FOR USE WITH THIS DOCUMENT.

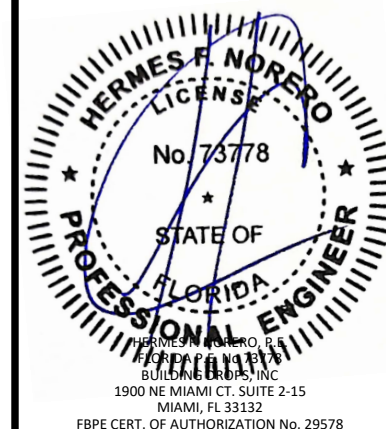

FL #:	FL46906
DATE:	07.12.2024
DWG. BY:	CHK. BY:
FB	HFN
SCALE:	NTS
DWG. #:	GIP008
SHEET:	5

c:\users\franciscobreno\building drops, inc\building drops landing - common\projects\global industries & mfg., inc. (global impact products)\fb-22-0537 - fbc submittal - r31158 aluminum fixed window\dwg\gip008 - (07.12).dwg 8/23/2024 2:55 PM

BILL OF MATERIALS				
ITEM	PART No.	DESCRIPTION	MATERIAL	MANUF./SUPPLIER/REMARKS
1	021-024	FRAME HEAD/SILL/JAMBS	6063-T5	ARCH ALUM
2	021-020	GLAZING STOP	6063-T5	-
3	012-003	DOW 995	SILICONE	DOW CORNING
4	015-008	SETTING BLOCK	NEOPRENE	FRANK LOWE RUBBR
5	015-007	WEDGE GASKET	VINYL	MASTER TOOL
6	015-006	0.150 SPACER	VINYL	FRANK LOWE RUBBR

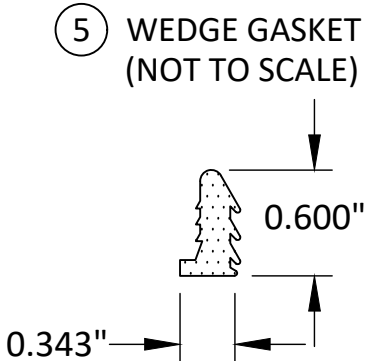
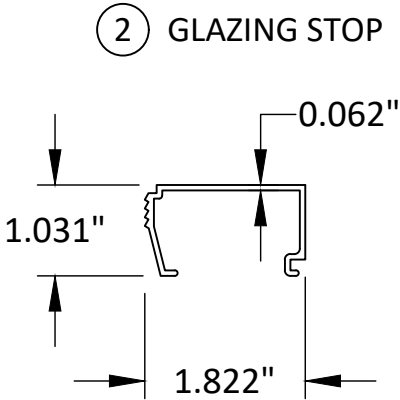
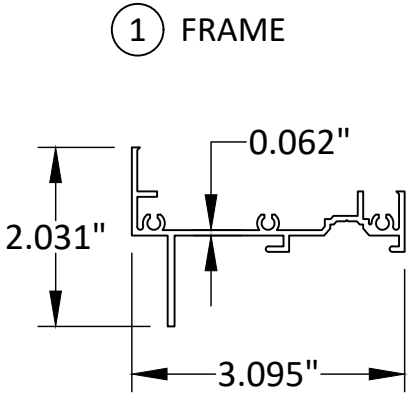

GLOBAL IMPACT PRODUCTS
1963 WEST MCNAB RD,
POMPANO BEACH, FL 33069
PH: (561) 346-3649

TITLE:
SERIES 3063 - FIXED ALUMINUM
WINDOW
(HVHZ/IMPACT)
COMPONENTS AND BILL OF
MATERIALS

PREPARED BY:
BUILDING DROPS, INC.
1900 NE MIAMI CT, SUITE 2-15
MIAMI, FL 33132
PH: (954)399-8478
FAX: (954)744-4738
WEB: www.buildingdrops.com

REMARKS	BY	DATE

THE INSTALLATION DETAILS DESCRIBED HEREIN ARE GENERIC AND MAY NOT REFLECT ACTUAL CONDITIONS FOR A SPECIFIC SITE. IF SITE CONDITIONS CAUSE INSTALLATION TO DEVIATE FROM THE REQUIREMENTS DETAILED HEREIN, A LICENSED ENGINEER OR ARCHITECT SHALL PREPARE SITE SPECIFIC DOCUMENTS FOR USE WITH THIS DOCUMENT.

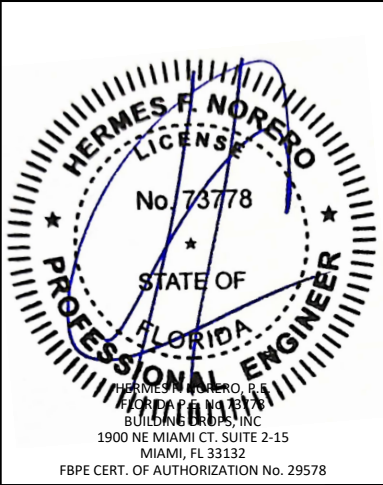

FL #:
FL46906

DATE: **07.12.2024**

DWG. BY:
FB

CHK. BY:
HFN

SCALE: **NTS**

DWG. #: **GIP008**

SHEET:
6
OF 6